

## PRESS RELEASE

13 December 2018

### **Paris Aéroport is expanding its gastronomic offering at the heart of Paris-Charles de Gaulle Airport**

The range of culinary delights available in the public area at Paris-Charles de Gaulle's Terminal 2E is set to grow with the arrival of three new food outlets. *Café Eiffel*, operated by Select Service Partner, will offer passengers and staff in Terminal 2E a high-quality dining experience with the ambiance of a French bistro. At *Ladurée*, the epitome of a Parisian tea room, customers can savour classic Chocolate-Caramel macarons with an indulgent cup of smoked tea. And last but not least, for those in a hurry and fans of fresh, natural food products, *Exki* offers an impressive range of meals and snacks, from breakfast to dinner, available to eat in or take away!

"Paris Aéroport is expanding its food and restaurant options. Between now and 2020, eight Michelin-starred chefs will be bringing their knowledge and expertise to our Paris airports. The opening of this new area dedicated to fine food and the French 'art de vivre' will help raise the quality of service we provide to our customers", explains Mathieu Daubert, Director of the Customer Division for Groupe ADP.

#### **Café Eiffel, the story of an encounter**

---

*Café Eiffel* was born from a meeting of two passions, two families, two men, each with their own knowledge and expertise, that came together to build a story based on the two strongest memories that any visitor to France takes home with them: gastronomy and engineering. On the one hand, the food. A quintessentially French restaurant. On the other hand, the Eiffel Tower and other elegant metal structures, seemingly suspended mid-air.

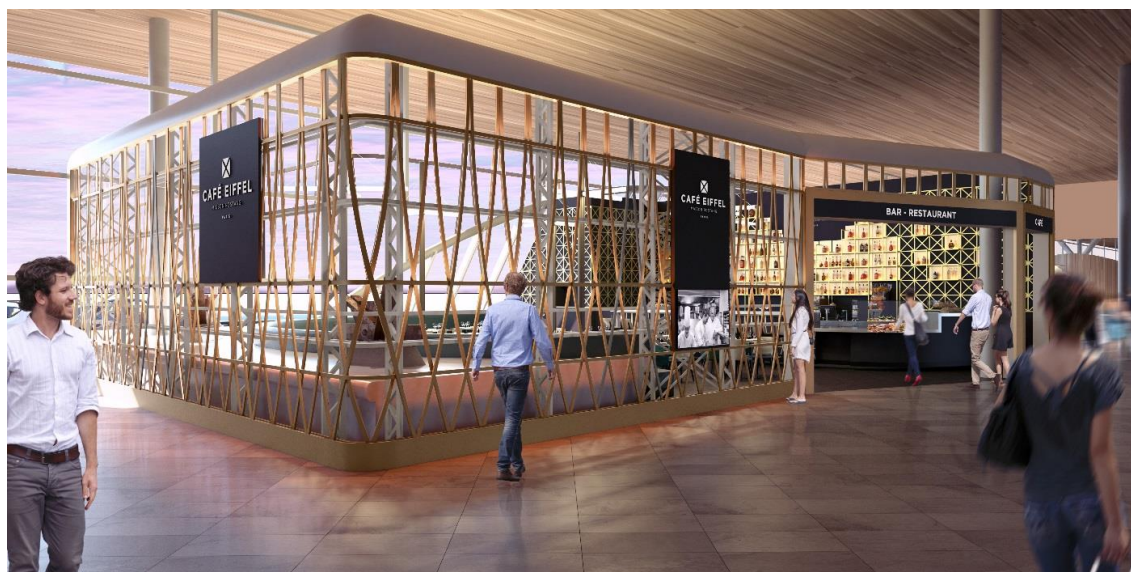

View of Café Eiffel - Terminal 2 - Paris-Charles de Gaulle airport © GROUPE ADP



Michel Rostang and Philippe Coupérie-Eiffel wanted to combine their respective skills and heritage and create a space that pays homage to the inventors and creative minds of France, and to the country itself. Combining their vision to establish a restaurant that prides itself on high-quality service, with a selection of dishes showcasing the best French produce, their goal was to introduce travellers to all aspects of what we call "technical proficiency".

*"We have carefully developed our food and restaurant options with a focus on innovation and quality. We are particularly proud of Paris Aéroport's partnership with Michel Rostang and Philippe Coupérie-Eiffel, with whom we share a passion for excellence and ensuring passengers have an experience that lives up to their expectations",* says Gérard d'Onofrio – Deputy CEO of SSP France - Belgium - Luxembourg.

Chefs Michel Rostang and Nicolas Beaumann from Maison Rostang have selected the finest products from local French producers renowned for their authenticity and savoir-faire: beef and veal from Polmard's butchers, cooked ham from Prince de Paris, seasonal truffles from Richerenches... And when it comes to the menu, the stand-out dishes at Café Eiffel are the perfect combination of indulgence and tradition. Highlights include the creamy free-range chicken, the melt-in-the-mouth duck parmentier, cod fillets with sauce vierge and the crispy tarte tatin.

The restaurant, open from 05:30 am to 10:30 pm, has meals suited to every time of day with seating for up to 72 people, as well as a "personalised" takeaway option (breads and fillings). *"Café Eiffel is a friendly place before a great start",* says Chief Michel Rostang.

### **The spirit of Gustave Eiffel**

The structure that houses *Café Eiffel* is itself a tribute to the world-famous Eiffel Tower. This invitation to travel offers passengers the chance to experience the magic of Paris before take-off.

*"Gustave Eiffel always made useful things. He brought people together to work on designs that served the greatest number. We kept this in mind when creating Café Eiffel, and its small exhibition on the great man himself. We wanted to remind world travellers that behind the Tower is a man, Gustave Eiffel, and that he brought joy and pride to the French people",* explains Philippe Coupérie-Eiffel.



View of Café Eiffel - Terminal 2 - Paris-Charles de Gaulle airport © GROUPE ADP

## A unique concept developed by Ladurée

---

Maison Ladurée opens its second exclusive “Le Macaron” outlet, dedicated to this iconic sweet treat. Passengers can discover the widest variety of macaron recipes with over 30 different flavours, including lavender, red berries, peach, chocolate, and even Earl Grey, the smoky recipe of which was especially created for the airport.



Boutique Maison Ladurée @Ladurée

## It's fresh, it's Exki

---

Exki's range of fresh, natural, additive-free products are available to eat in or takeaway. It offers a full range of breakfast options, a wide selection of original salads and sandwiches, homemade soups and vegetarian quiches. Not to mention its delicious desserts! Some products (bread, dairy products, jams, etc.) are certified organic.

Open every day from 05:30 am to 10:30 pm, this Exki outlet has seating for 76 people.

**Press contact:** Lola Bourget, Head of Media and Reputation Department +33 1 74 25 23 23

**Investor Relations:** Audrey Arnoux, Head of Investor Relations +33 1 74 25 70 64 - [invest@adp.fr](mailto:invest@adp.fr)

Groupe ADP develops and manages airports, including Paris-Charles de Gaulle, Paris-Orly and Paris-Le Bourget. In 2017, the Group handled through its brand Paris Aéroport more than 101 million passengers and 2.3 million metric tonnes of freight and mail at Paris-Charles de Gaulle and Paris-Orly, and more than 127 million passengers in airports abroad through its subsidiary ADP International. Boasting an exceptional geographic location and a major catchment area, the Group is pursuing its strategy of adapting and modernizing its terminal facilities and upgrading quality of services; the Group also intends to develop its retail and real estate businesses. In 2017, Group revenue stood at €3,617 million and net income at €571 million. Registered office: 1, rue de France, 93 290 Tremblay-en-France.

Aéroports de Paris is a public limited company (Société Anonyme) with share capital of €296,881,806. Registered in the Bobigny Trade and Company Register under no. 552 016 628. [www.groupeadp.com](http://www.groupeadp.com)